

ASSEMBLY AND PART DRAWING

WATER-COOLED DIESEL ENGINE

KD488

KIPOR

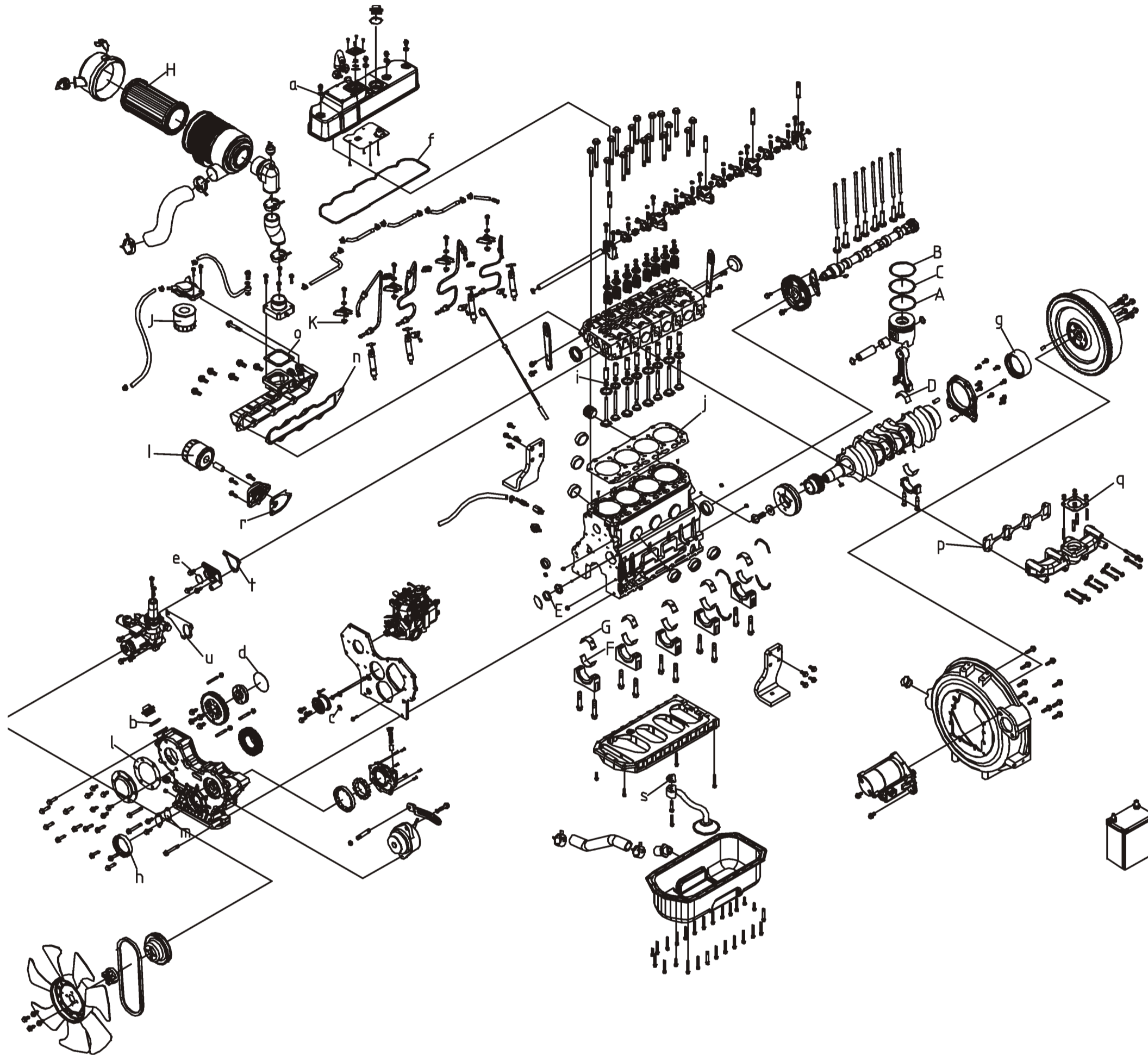

Easy Wearing Parts

No.	Part No.	Description	Qty.	Amounted to
A	KD388-04100	Oil Ring Part	4	Piston Connection Rod Assembly
B	KD388-04001	The 1st Air Ring	4	Piston Connection Rod Assembly
C	KD388-04002	The 2nd Air Ring	4	Piston Connection Rod Assembly
D	KD388-04005	Connection Rod Bushing	8	Piston Connection Rod Assembly
E	KD388-01107	Camshaft Bush	2	Cylinder Block Assembly
F	KD388-01024	Lower Main Bushing	5	Cylinder Block Assembly
G	KD388-01025	Upper Main Bushing	5	Cylinder Block Assembly
H	KD388-07300	Air Filter Element Part	1	Inlet System
I	KD388-09300	Oil Filter Part	1	Lubricating System
J	KD388-10320	Fuel Filter Part	1	Fuel Supplying System
K	KD388-10022	Heat Insulation Sleeve of Fuel Injector	4	Fuel Supplying System

O-Seal Ring

No.	Part No.	Description	Qty.
a	GB/T3452.1-1992	O-Seal Ring 11.8X2.65	3
b	GB/T3452.1-1992	O-Seal Ring 31.5X3.55	2
c	KD388-01011	O-Seal Ring 15.6X2.4	2
d	GB/T3452.1-1992	O-Seal Ring 66X3.55	1
e	GB/T3452.1-1992	O-Seal Ring 29.7X3	1
f	KD488-03002	Cylinder Cover Seal Ring	1

Tighten Torque for Main Bolts and Nuts (N.m)

No.	Description	Torque
①	Main Bearing Bolt	115-125
②	Cylinder Cover Bolt	75-85
③	Tighten Bolt of Valve Rocker Arm	20-26
④	Connection Rod Bolt	55-65
⑤	Flywheel Bolt	65-75
⑥	Crankshaft Belt Bolt	170-190
⑦	Tighten Bolt for Camshaft Thrust	20-23

Gasket

No.	Part No.	Description	Qty.
j	KD488-01200	Cylinder Cover Gasket	1
l	KD388-01005	Fuel Injection Pump Cover Gasket	1
m	KD388-01045	Cover Plate Gasket	1
n	KD488-07002	Inlet Pipe Gasket	1
o	KD388-07003	Inlet Connection Pipe Flange Gasket	1
p	KD388-08002	Exhaust Pipe Gasket	1
q	KD388-08003	Outlet Pipe Gasket	1
r	KD388-09002	Oil Filter Seat Gasket	1
s	KD388-09004	Rough Filter Gasket	1
t	KD388-17002	Water Outlet Seat Gasket	1
u	KD388-17003	Water Pump Gasket	1

Oil Seal

No.	Part No.	Description	Qty.
g	KD388-01009	Oil Seal of Flywheel	1
h	KD388-01003	Oil Seal of Gear Box	1
i	KD388-02005	Oil Seal of Valve Conduct Pipe	8

WUXI KIPOR POWER CO., LTD

Add: Beside Jingyi Rd, Third-stage Development Section of Wangzhuang Industry Area,
Wuxi High & New Technology Industry Development Zone Tel: 0510-85205041 Fax: 0510-85203796

